

North

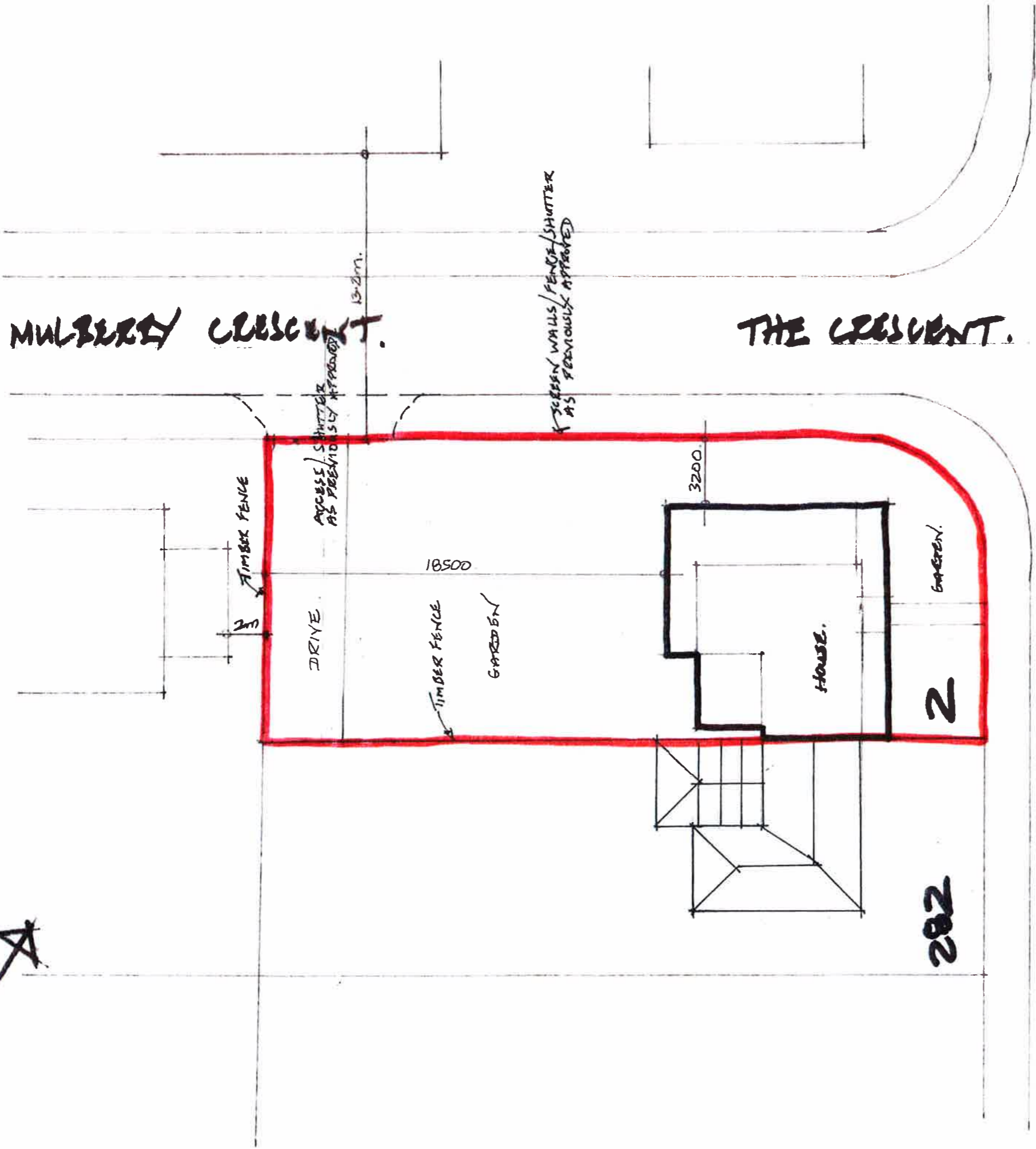

SUNDERLAND ROAD

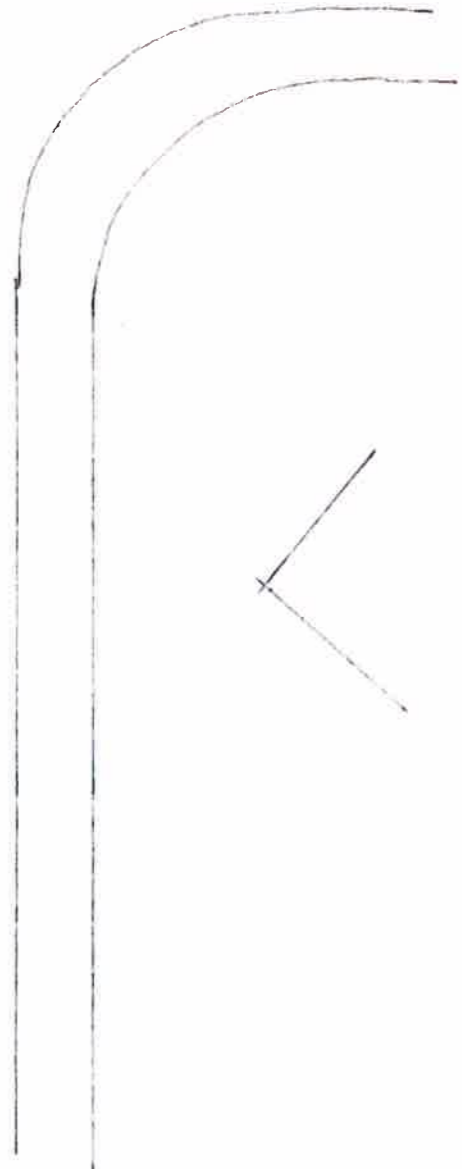

LILAC AVENUE.

EXISTING BLOCK PLAN 1:200.

U.A.

**CSM+**  
ARCHITECTS  
1 Boyd Street  
Sunderland  
Newcastle upon Tyne  
NE2 6AP  
Tel: +44 (0) 191 260-3450  
Fax: +44 (0) 191 261-7301  
E-mail: [edmin@csmarchitects.co.uk](mailto:edmin@csmarchitects.co.uk)  
Web Site: [www.csmarchitects.co.uk](http://www.csmarchitects.co.uk)